

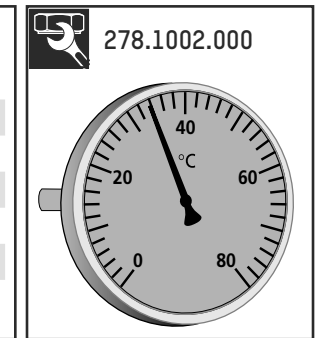

	↑	D mm
3/4"	-	76
1"	-	77
1 1/4"	-	77
3/4"	✓	81
1"	✓	82
1 1/4"	✓	82



EN15092
KTW / W270
TÜV

 298.5280.000
3/4", 1", 1 1/4"

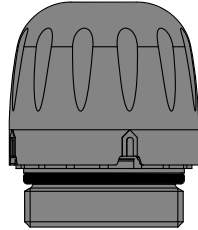
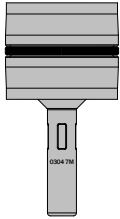



298.5281.000	45-65°C	3/4"
298.5282.000	45-65°C	1"
298.5283.000	45-65°C	1 1/4"
298.5284.000	35-70°C	3/4"
298.5284.000	35-70°C	1"
298.5285.000	35-70°C	1 1/4"

Version 45-65°C (EN 15092)

253.1002.____
253.1003.____
253.1004.____
253.1102.____
253.1103.____
253.1104.____

Version 35-70°C

253.2002.____
253.2003.____
253.2004.____
253.2102.____
253.2103.____
253.2104.____

TB 	PB 	DN	G	
100°C	10 bar	15	3/4"	-
100°C	10 bar	20	1"	-
100°C	10 bar	25	1 1/2"	-
90°C	10 bar	15	3/4"	✓
90°C	10 bar	20	1"	✓
90°C	10 bar	25	1 1/2"	✓

 3/4" | DN 15

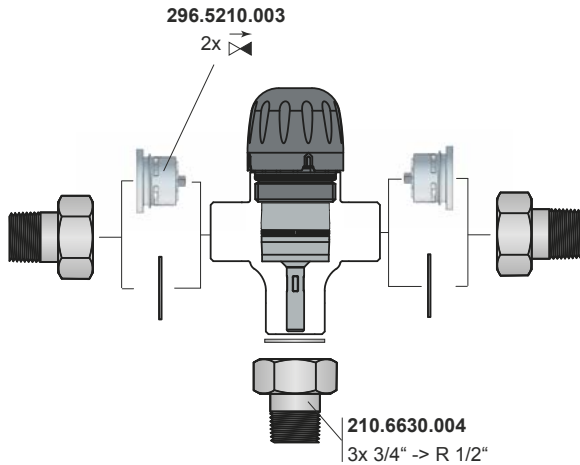

 1" | DN 20

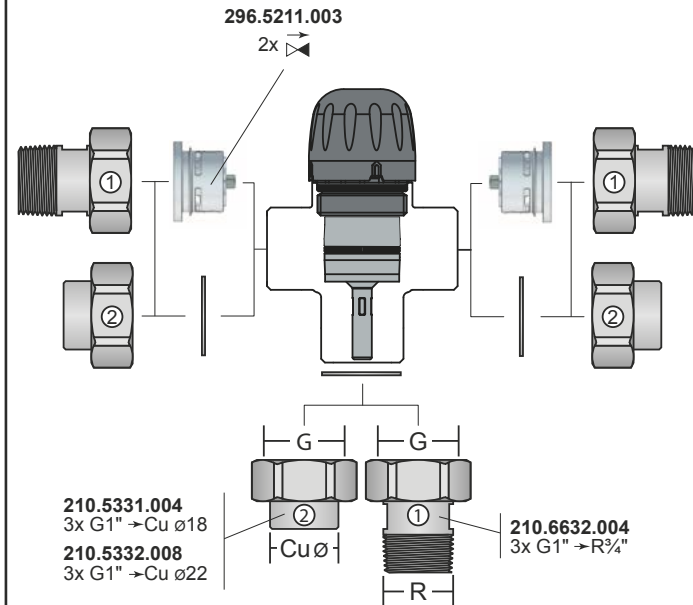

 1 1/4" | DN 25

